

DIGITAL
PROJECTOR

MX620ST



Features

- Native XGA (1280x800) Resolution
- 3,000 ANSI Lumens; 13,000:1 Contrast Ratio
- Wireless Display / USB Reader & Display
- Up to 10,000 Hours Long Lamp Life
- SmartEco™ Power Saving Technology
- 3D PC & Blu-Ray Ready
- 10W Speaker



Input and Output Terminals

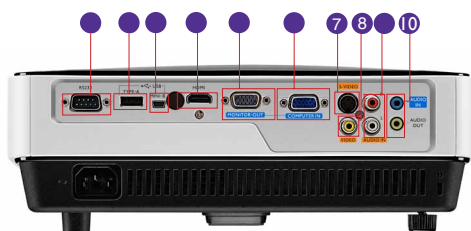

- | | |
|-----------------------------|-----------------------------|
| 1 RS232 (DB-9pin) | 6 Computer in (D-sub 15pin) |
| 2 USB (Type A) | 7 S-Video (Mini DIN 4-pin) |
| 3 USB (Type Mini-B) | 8 Composite Video in |
| 4 HDMI | 9 Audio in L/R (RCA) |
| 5 Monitor Out (D-sub 15pin) | 10 Audio In/Out (Mini Jack) |

Specifications

Projection System	DLP®																										
Native Resolution	XGA (1024x768)																										
Brightness	3000AL																										
Contrast Ratio	13000:1																										
Display Color	1.07 Billion Colors																										
Lens	F=2.6-2.78, f=10.2-12.24mm																										
Aspect Ratio	Native 4:3 (5 aspect ratio selectable)																										
Throw Ratio	0.9~1.08 (54.5"±3% @ 1m)																										
Image Size Diagonal	32"~300"																										
Zoom Ratio	1.2:1																										
Lamp Type	190W																										
Lamp(Normal/Economic/SmartEco/LampSave)*	4500/6000/6500/10000 hours																										
Keystone Adjustment	1D, Vertical +/- 40 degrees																										
Projection Offset	110%±5%																										
Resolution Support	VGA(640 x 480) to UXGA(1600 x 1200)																										
Horizontal Frequency	15~102KHz																										
Vertical Scan Rate	23~120Hz																										
Compatibility	HDTV Compatibility: 480i, 480p, 576i, 576p, 720p, 1080i, 1080p Video Compatibility: NTSC, PAL, SECAM																										
Interface	<table border="0"> <tbody> <tr> <td>Computer in (D-sub 15pin)</td><td>x 1(Share with component)</td></tr> <tr> <td>Monitor out (D-sub 15pin)</td><td>x 1</td></tr> <tr> <td>Composite Video in (RCA)</td><td>x 1</td></tr> <tr> <td>S-Video in (Mini DIN 4pin)</td><td>x 1</td></tr> <tr> <td>HDMI</td><td>x1</td></tr> <tr> <td>Audio in (Mini Jack)</td><td>x 1</td></tr> <tr> <td>Audio out (Mini Jack)</td><td>x 1</td></tr> <tr> <td>Audio L/R in (RCA)</td><td>x 1</td></tr> <tr> <td>Speaker</td><td>10W x 1</td></tr> <tr> <td>USB (Type A)</td><td>x 1 (Download & page/down)</td></tr> <tr> <td>USB (Type Mini-B)</td><td>x 1</td></tr> <tr> <td>RS232 (DB-9pin)</td><td>x 1</td></tr> <tr> <td>IR Receiver</td><td>x2 (Front+Rear)</td></tr> </tbody> </table>	Computer in (D-sub 15pin)	x 1(Share with component)	Monitor out (D-sub 15pin)	x 1	Composite Video in (RCA)	x 1	S-Video in (Mini DIN 4pin)	x 1	HDMI	x1	Audio in (Mini Jack)	x 1	Audio out (Mini Jack)	x 1	Audio L/R in (RCA)	x 1	Speaker	10W x 1	USB (Type A)	x 1 (Download & page/down)	USB (Type Mini-B)	x 1	RS232 (DB-9pin)	x 1	IR Receiver	x2 (Front+Rear)
Computer in (D-sub 15pin)	x 1(Share with component)																										
Monitor out (D-sub 15pin)	x 1																										
Composite Video in (RCA)	x 1																										
S-Video in (Mini DIN 4pin)	x 1																										
HDMI	x1																										
Audio in (Mini Jack)	x 1																										
Audio out (Mini Jack)	x 1																										
Audio L/R in (RCA)	x 1																										
Speaker	10W x 1																										
USB (Type A)	x 1 (Download & page/down)																										
USB (Type Mini-B)	x 1																										
RS232 (DB-9pin)	x 1																										
IR Receiver	x2 (Front+Rear)																										
Dimensions (WxHxD)	11.3" x 4.5" x 9.15" (w/ feet)																										
Weight	5.06lbs (2.6kg)																										
Power Supply	AC100 to 240 V, 50 to 60 Hz																										
Power Consumption	270W(typical), 220W (Eco), Standby<0.5W																										
Audible Noise	33/28 dBA (Normal/Economic mode)																										
On-Screen Display Languages	Arabic/Bulgarian/ Croatian/ Czech/ Danish/ Dutch/ English/ Finnish/ French/ German/ Greek/ Hindi/ Hungarian/ Italian/ Indonesian/ Japanese/ Korean/ Norwegian/ Polish/ Portuguese/ Romanian/ Russian/ Simplified Chinese/Spanish/ Swedish/ Turkish/ Thai/ Traditional Chinese (28 Languages)																										
Picture Mode	Dynamic/Presentation/sRGB/Cinema/User 1/User 2																										
Accessories (Standard)	Lens Cover, Remote Control w/ Battery, Power Cord, User Manual CD, Quick Start Guide, Warranty Card, VGA (D-sub 15 pin) Cable																										
Accessories (Optional)	<table border="0"> <tbody> <tr> <td>Spare Lamp Kit</td><td>P/N: 5J.J9V05.001</td></tr> <tr> <td>Ceiling Mount</td><td>P/N: 5J.J4N10.001</td></tr> <tr> <td>3D Glasses</td><td>P/N: 5J.J7K25.001</td></tr> <tr> <td>Carry Bag</td><td>P/N: 5J.J4R09.001</td></tr> </tbody> </table>	Spare Lamp Kit	P/N: 5J.J9V05.001	Ceiling Mount	P/N: 5J.J4N10.001	3D Glasses	P/N: 5J.J7K25.001	Carry Bag	P/N: 5J.J4R09.001																		
Spare Lamp Kit	P/N: 5J.J9V05.001																										
Ceiling Mount	P/N: 5J.J4N10.001																										
3D Glasses	P/N: 5J.J7K25.001																										
Carry Bag	P/N: 5J.J4R09.001																										
UPC Code / Part #	8400460-2858-9 / 9H.J9V77.13A																										
Limited Warranty	1 Year Parts & Labor / 180 Days or 500 Hours of Lamp Life																										

*Lamp life results will vary depending on environmental conditions and usage. Actual product's features and specifications are subject to change without notice.

HDMI
HIGH-DEFINITION MULTIMEDIA INTERFACE

NEW 3D

SmartEco

10,000 hours lamp life



BenQ America Corp.
www.BenQ.us

BenQ is a registered trademark of BenQ Corp. DLP is a registered trademark of Texas Instruments. All rights reserved. Product names, logos, brands, and other trademarks featured or referred to in this materials are the property of their respective trademark holders. Specifications subject to change without notice.

MX620ST 11-04-13-BQca

BenQ

MX620ST Digital Projector

Distance Chart

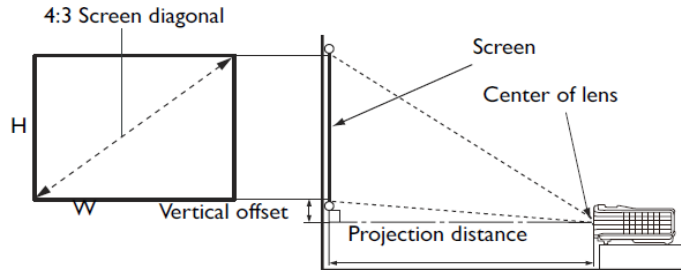

Screen Size				Distance from screen (mm)			Vertical offset (mm)
Diagonal		W (mm)	H (mm)	Min length	Average	Min length	
Inch	mm			Max zoom		Max zoom	
40	1016	32	24	28.9	31.7	34.6	1.18
50	1270	40	30	36.1	39.7	43.3	1.49
60	1524	48	36	43.3	47.6	52.0	1.81
80	2032	64	48	57.7	63.5	69.3	2.4
100	2540	80	60	72.2	79.4	86.6	2.9
120	3048	96	72	86.6	95.3	104.0	3.5
150	3810	120	90	108.3	119.2	130.0	4.4
200	5080	160	120	144.5	158.9	173.3	5.9
220	5588	176	132	158.9	174.8	190.7	6.6
250	6350	200	150	180.5	198.6	216.7	7.5
300	7620	240	180	216.7	238.3	260.1	9.0

Ceiling Mount Chart

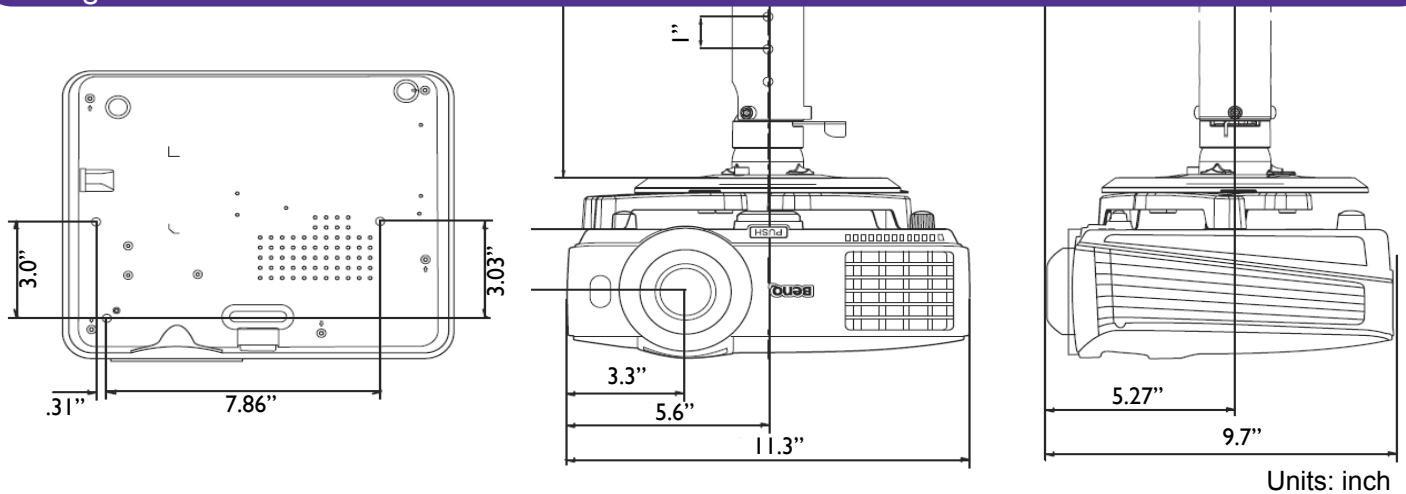

Units: inch

Dimensions

